

REX FARMS SUB PHASE 3

CENTER TOWNSHIP SECTION 18 R10- TWP 6 MORGAN COUNTY, OH

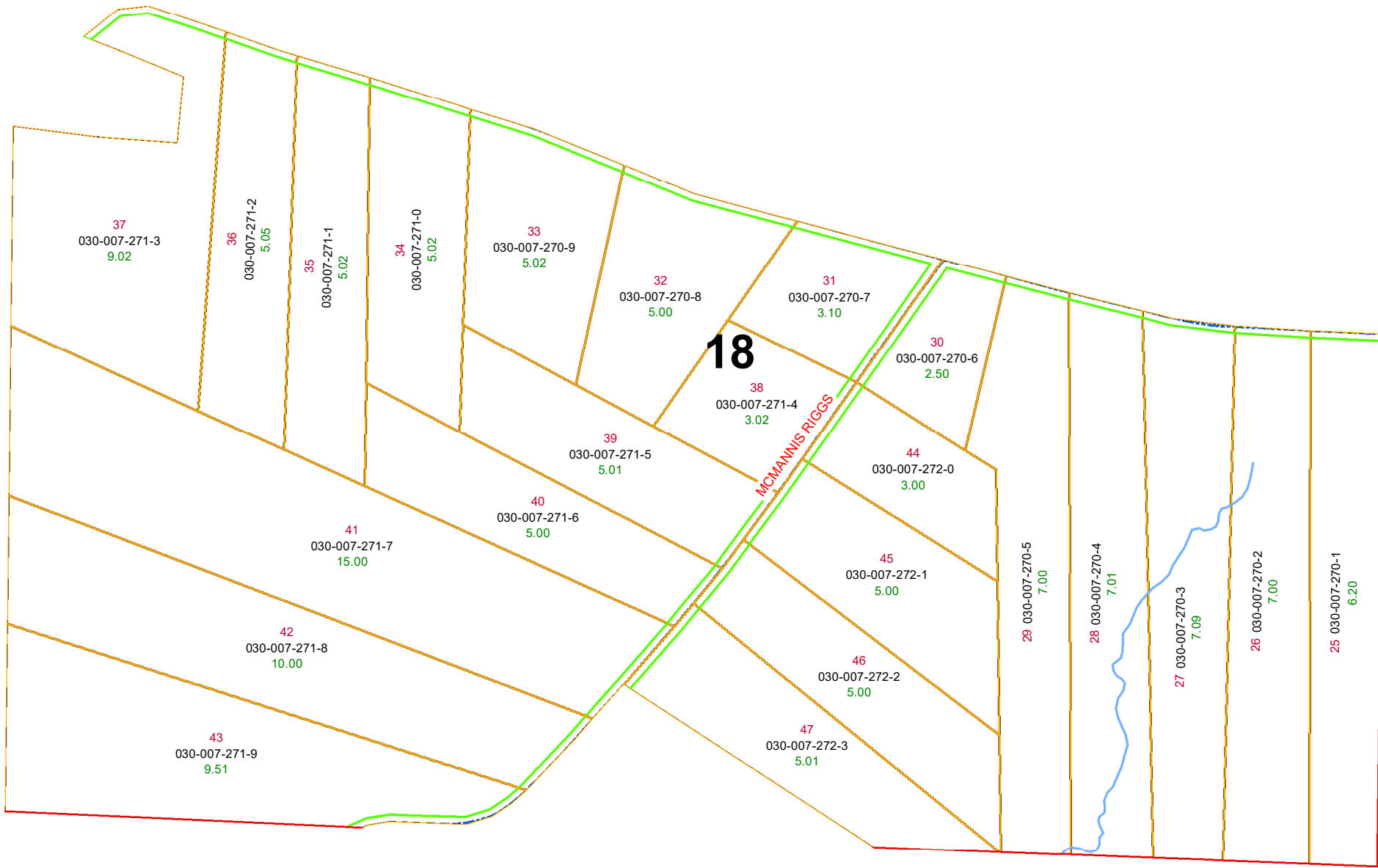

PIN	VOL	PAGE	Owner	LegalDescr	Acres
030-007-271-8	OR206	3227	BALL RENE A	R10 T06 S18 REX FA	10.002
030-007-271-7	OR206	3227	BALL RENE A	R10 T06 S18 REX FA	15.002
030-007-271-1	OR224	1051	BINEGAR ALAN BLAIR JR & KAYLA MA	R10 T06 S18 REX FA	5.029
030-007-271-2	OR224	1051	BINEGAR ALAN BLAIR JR & KAYLA MA	R10 T06 S18 REX FA	5.05
030-007-271-3	OR224	1051	BINEGAR ALAN BLAIR JR & KAYLA MA	R10 T06 S18 REX FA	9.024
030-007-270-1	OR207	432	KERNEN CLIFTON A & WANITA K TOD-	R10 T06 S18 REX FA	6.208
030-007-270-2	OR207	432	KERNEN CLIFTON A & WANITA K TOD-	R10 T06 S18 REX FA	7.002
030-007-272-0	OR195	503	LONG CHRISTY J & ANGELA K	R10 T06 S18 REX FA	3.008
030-007-272-1	OR211	2498	LONG JOSEPH A & KATIE R LC-DONNIE	R10 T06 S18 REX FA	5.002
030-007-271-9	OR233	3027	REED CHANCE & TRICIA ALEXIS	R10 T06 S18 REX FA	9.511
030-007-272-2	OR220	3064	TOMPKINS RANDY & DOROTHY	R10 T06 S18 REX FA	5.003
030-007-270-3	OR215	718	TOMPKINS RANDY & DOROTHY	R10 T06 S18 REX FA	7.094
030-007-270-4	OR218	718	TOMPKINS RANDY & DOROTHY	R10 T06 S18 REX FA	7.012
030-007-270-6	OR215	718	TOMPKINS RANDY & DOROTHY	R10 T06 S18 REX FA	2.507
030-007-270-8	OR220	3064	TOMPKINS RANDY & DOROTHY	R10 T06 S18 REX FA	5.008
030-007-271-4	OR215	718	TOMPKINS RANDY C & DOROTHY A	R10 T06 S18 REX FA	3.022
030-007-270-5	OR222	751	TOMPKINS RANDY C & DOROTHY A	R10 T06 S18 REX FA	7.008
030-007-270-7	OR215	718	TOMPKINS RANDY C & DOROTHY A	R10 T06 S18 REX FA	3.106
030-007-271-6	OR212	347	WICKHAM CASEY P & LACEY R	R10 T06 S18 REX FA	5.002
030-007-271-5	OR212	347	WICKHAM CASEY PAUL & LACEY RAE	R10 T06 S18 REX FA	5.01
030-007-270-9	OR209	362	WICKHAM JEREMY LEE	R10 T06 S18 REX FA	5.022
030-007-271-0	OR204	1715	WICKHAM JEREMY LEE	R10 T06 S18 REX FA	5.02
030-007-272-3	OR198	1	YOUNG DOUGLAS A & ELLEN L FLOW	R10 T06 S18 REX FA	5.01

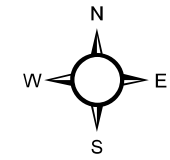

 Sections	— Hydro	 Parcels
Boundaries	— Lot	 Roads
Type	— Parcel	
 Hidden	— ROW	

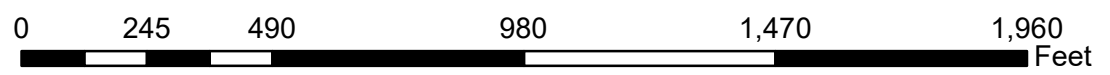

Source: Morgan County Engineer's Office
 Author: Marcia Wolfe
 Date: 3/18/2020

Disclaimer: The information that these maps contains is or reference purposes only. Please bring any erros to the attention of the Engineer's Office staff.
 Thank you